

# PIE CHART

You are going to produce a pie chart showing the fares collected by a coach company in the six counties of Northern Ireland in 2012.

Enter the following data:

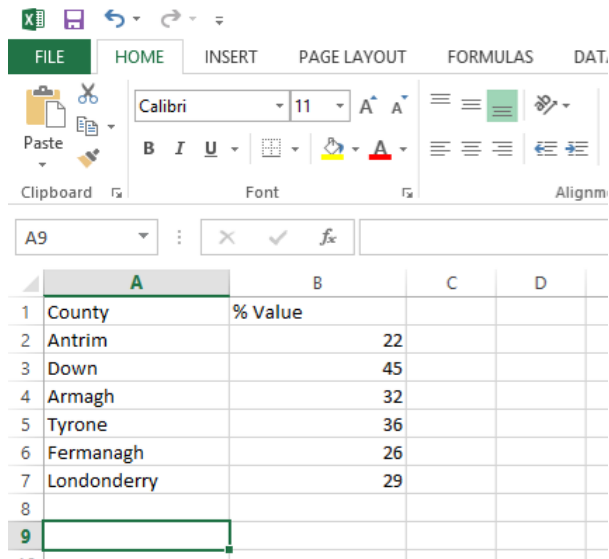

County	% Value
Antrim	22
Down	45
Armagh	32
Tyrone	36
Fermanagh	26
Londonderry	29

Save the data using the filename **FARES**

**TO SAVE IN Excel 2016**

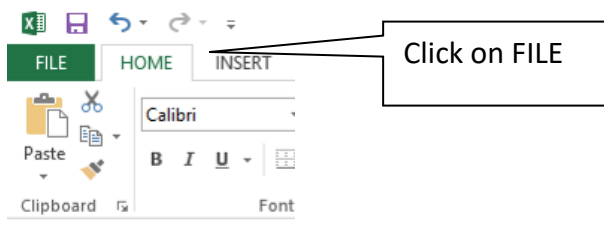

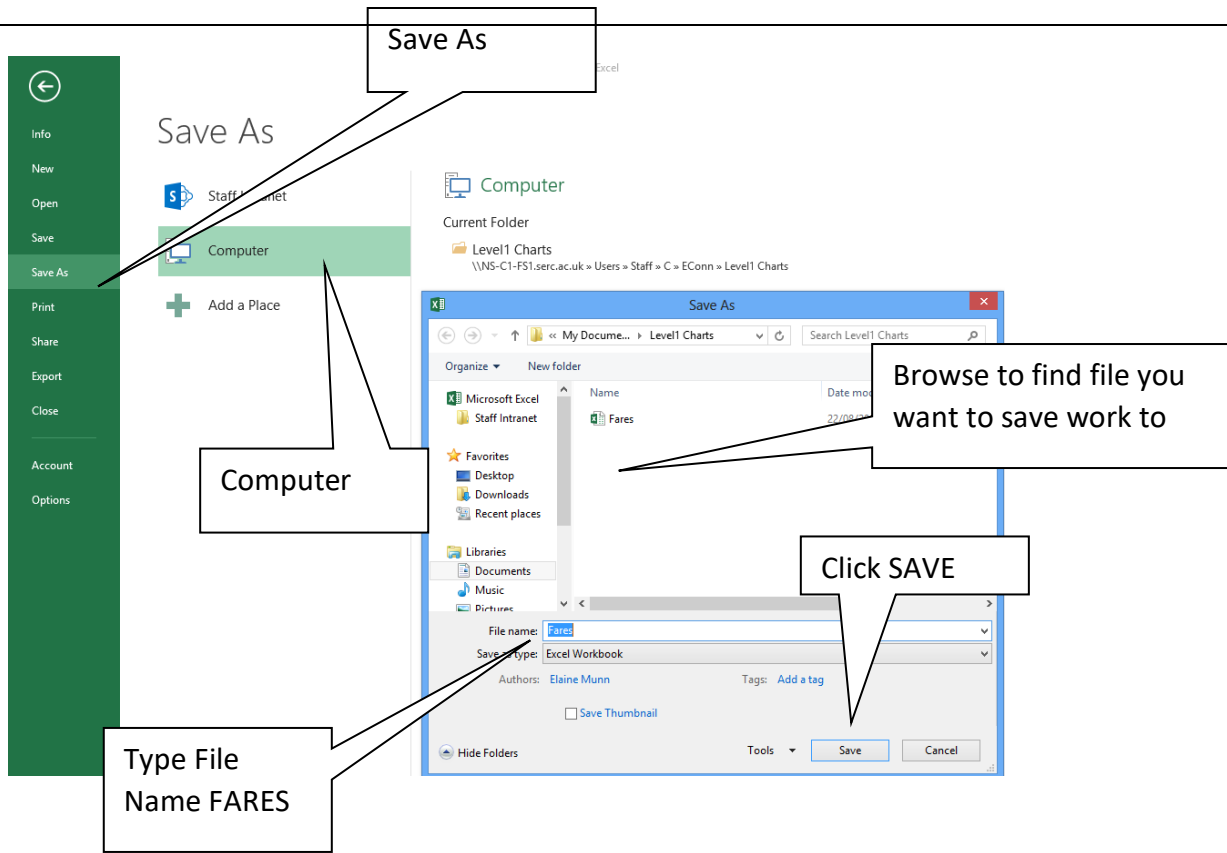

## Create PIE CHART

### 1. Highlight the Columns A1 to B7

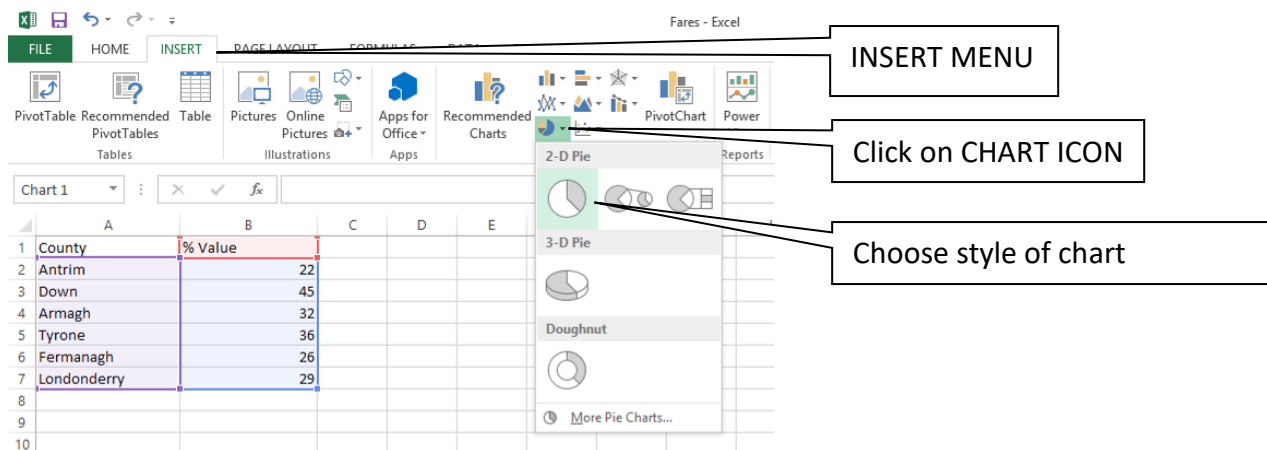

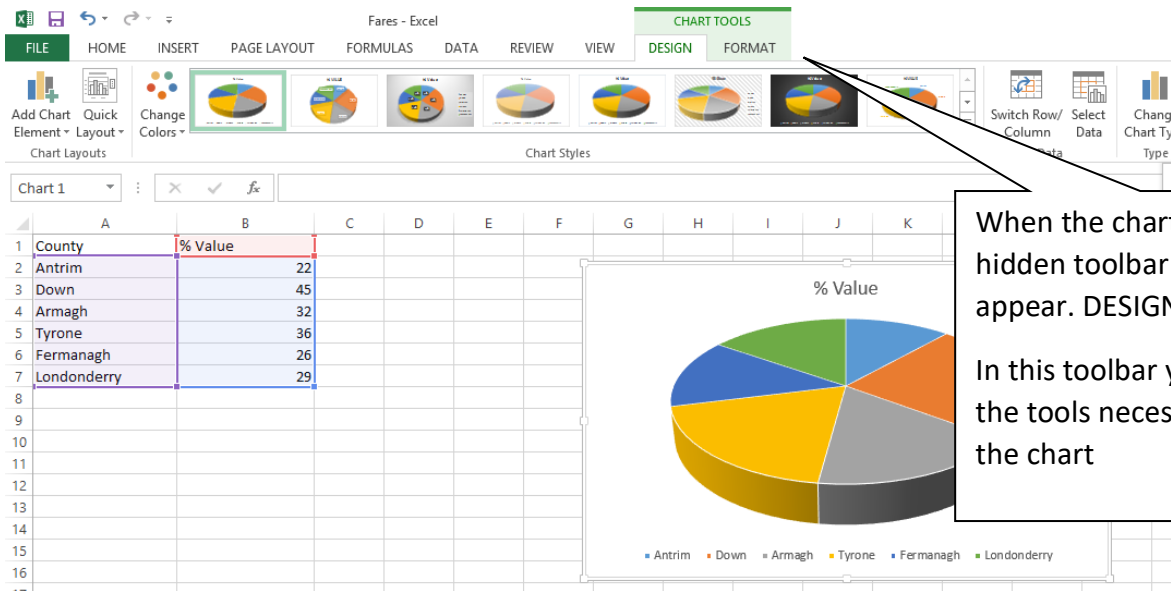

## MOVE CHART TO A PAGE OF ITS OWN

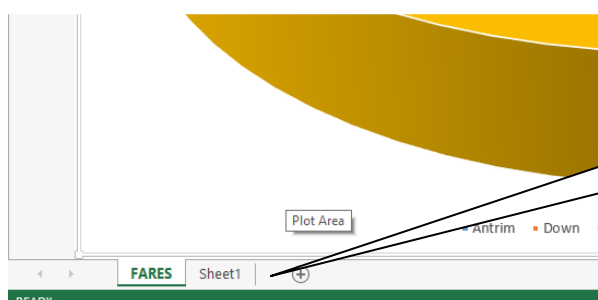
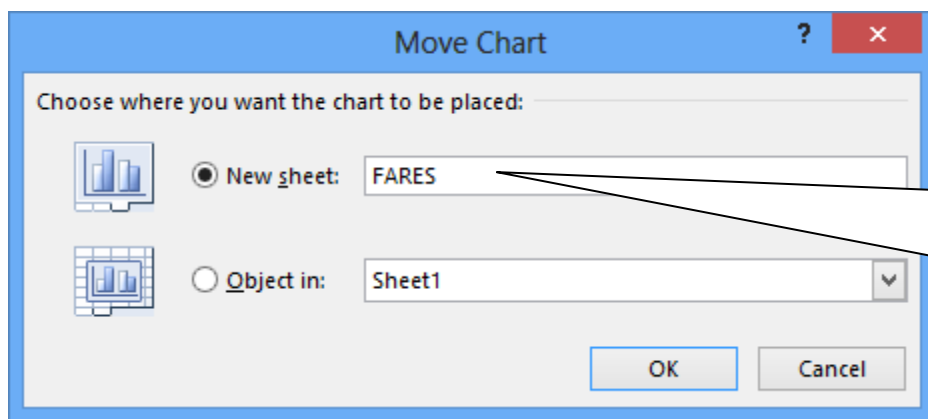
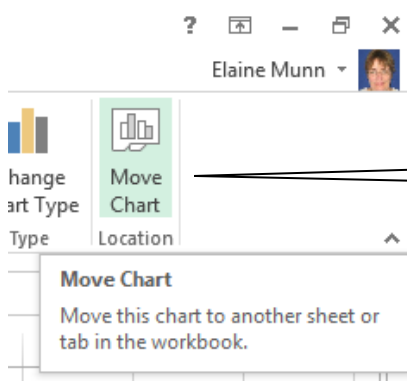

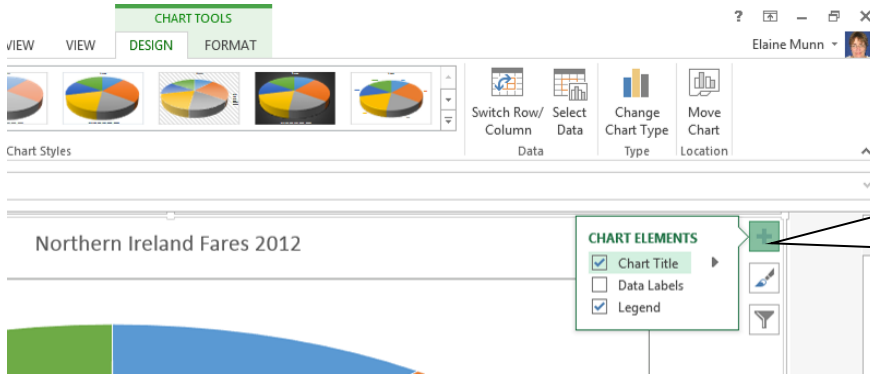

Click on the **PLUS**  
Add a Chart Title – Northern Ireland Fares 2012

## ADD A LEGEND

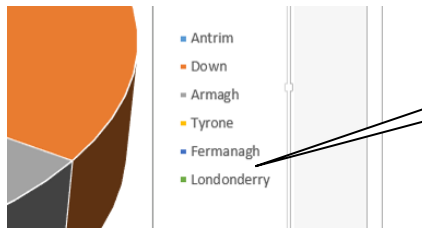

This gives you the "KEY"

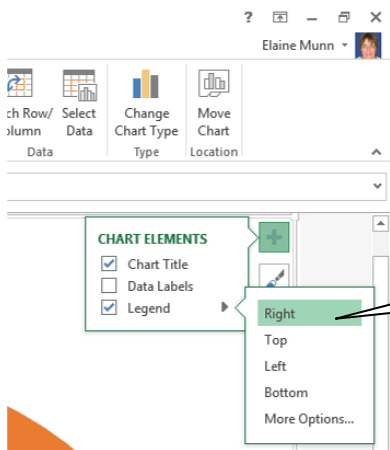

By clicking on the arrow you can decide where you want the Legend to be located on the chart

## ADD DATA LABELS

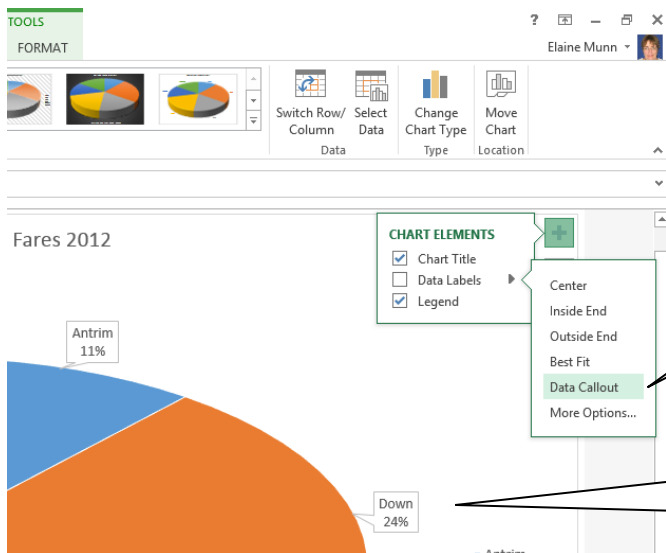

By clicking on the arrow you can decide what type of data labels you want for your chart.

The data Label gave me % percent. I want to change the data label to show numbers

# CHANGING THE DATA LABELS TO SHOW NUMBERS

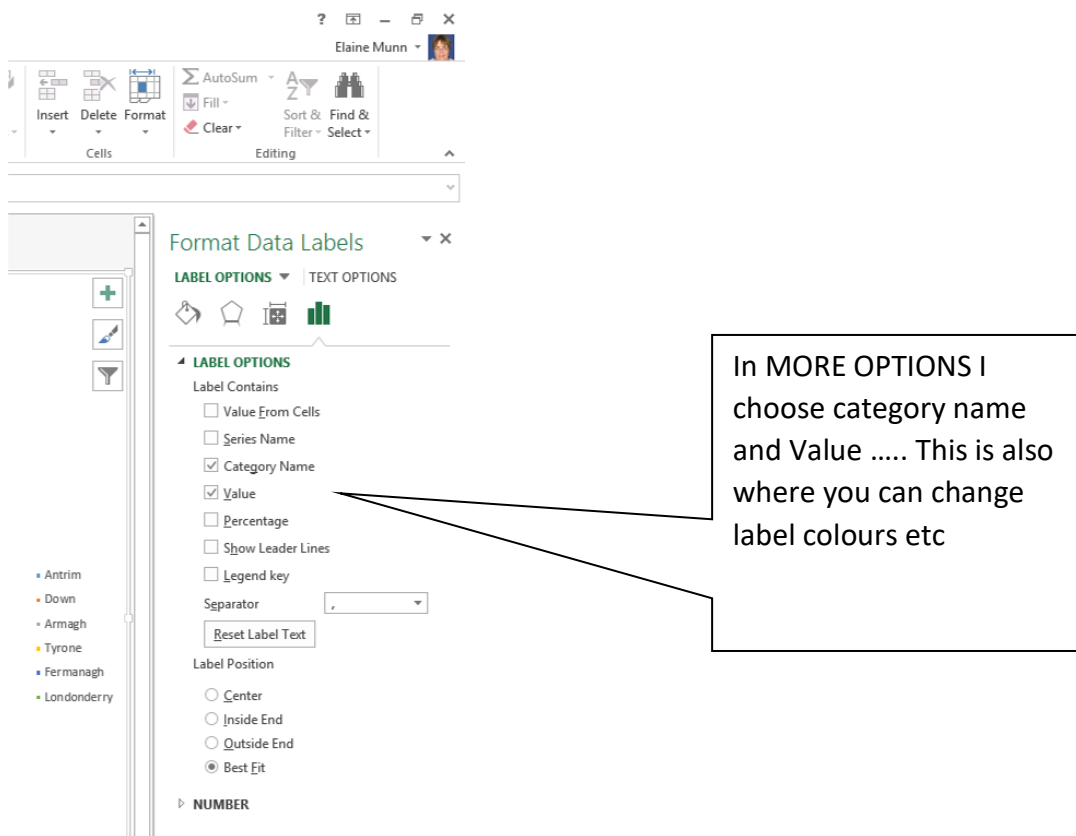
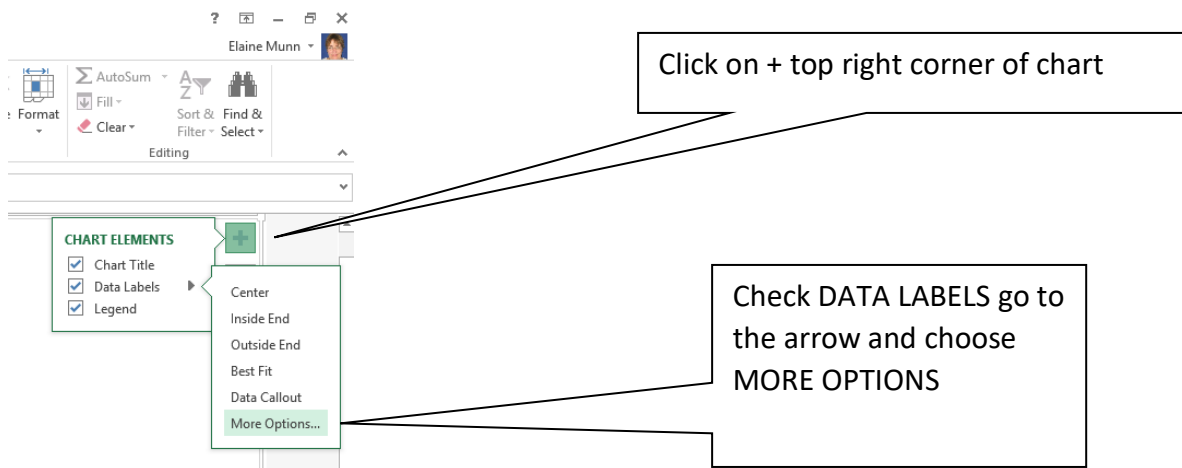

## DATA LINKED WITH CHART

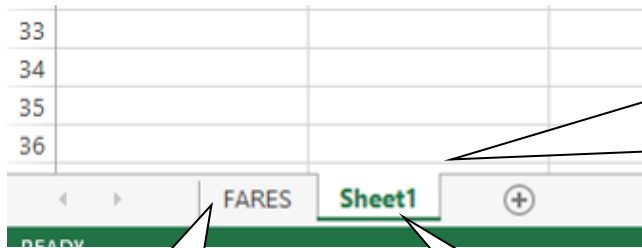

### BOTTOM LEFT OF WORKSHEET

Clicking on the different tabs brings you to the different worksheets

Pie Chart TAB - FARES

DATA TAB - sheet 1

## Go to SHEET 1

A screenshot of the Excel ribbon showing the 'HOME' tab. The font settings are Calibri, size 11. The data table below shows the following values:

County	% Value
Antrim	43
Down	45
Armagh	32
Tyrone	36
Fermanagh	26
Londonderry	29

Change the data for ANTRIM to 43 (instead of 22)

Northern Ireland Fares 2012

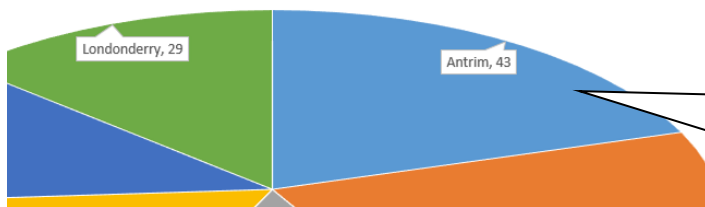

Go to the Pie Chart worksheet FARES. Note that the pie segment changed to match the data

## Save your chart as FARES